

**Drain:** WINDHAMMER DRAIN **Drain #:** 218  
**Improvement/Arm:** WINDHAMMER EXTENSION  
**Operator:** JOH **Date:** 6-28-04  
**Drain Classification:** Urban/Rural **Year Installed:** 1989

### GIS Drain Input Checklist

- Pull Source Documents for Scanning JOH
- Digitize & Attribute Tile Drains N/A
- Digitize & Attribute Storm Drains JOH
- Digitize & Attribute SSD N/A
- Digitize & Attribute Open Ditch N/A
- Stamp Plans N/A
- Sum drain lengths & Validate JOH
- Enter Improvements into Posse JOH
- Enter Drain Age into Posse JOH
- Sum drain length for Watershed in Posse JOH
- Check Database entries for errors JOH

**Gasb 34 Footages for Historical Cost  
Drain Length Log**

Drain-Improvement: WINDYBROOK DRAIN - WINDYBROOK EXTENSION

Drain Type:	Size:	Length <i>Submittal Request</i>	Length (DB Query)	Length Reconcile	If Applicable	
					Price:	Cost:
CAD	36"	302'	302'	Ø	67.00	20,234.00

Sum:            302'     302'     Ø                     \_\_\_\_\_

Final Report: \_\_\_\_\_

Comments:

\_\_\_\_\_

\_\_\_\_\_

\_\_\_\_\_

\_\_\_\_\_

\_\_\_\_\_



SURVEYOR'S OFFICE

# Hamilton County

Kenton C. Ward, Surveyor

776-9626

942 Maple Avenue

Noblesville, Indiana 46060

November 21, 1989

TO: Hamilton County Drainage Board

RE: Windjammer Drain

*2/20 Tuesday  
9:00am*

*mail  
1/19*

Attached is a petition for the extension of the Windjammer Drain filed by the County Commissioners. The extension involves a section of storm sewer between Fall Creek Road and Geist Reservoir. Included with the petition is a plan of the drain, drainage assessment roll, and an easement.

As per the report dated May 30, 1989 for the Windjammer Drain, the regulated drain ends at north side of Fall Creek Road at the north end of a 36" pipe. This proposal will extend the drain from the above described point to the Geist Reservoir. The drain extension will consist of 302 feet of 36" CMP.

Easement for the drain was increased from that which was platted as part of sections 8 and 9 of the Masthead Subdivision. The additional easement is located on Lot 263 in Masthead Section 8 and is recorded as instrument number 8913832.

As part of the Windjammer Drain, this portion described above as the extension and shown on the plan will be covered under the maintenance program established for the Windjammer Drain. Two parcels should be added to the maintenance assessment for Windjammer. These parcels are Lot 263, Masthead Section 8, Parcel 13-15-09-03-02-001.000 and Lot 264, Masthead Section 9, Parcel 13-15-09-00-01-001.000.

These tracts should be assessed the same as the other tracts in the Windjammer Drain at the rate of \$30.00 per lot.

I recommend a hearing be set for this matter in January, 1990.

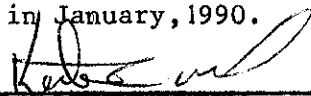
  
\_\_\_\_\_  
Kenton C. Ward,  
Hamilton County Surveyor

KCW/jb

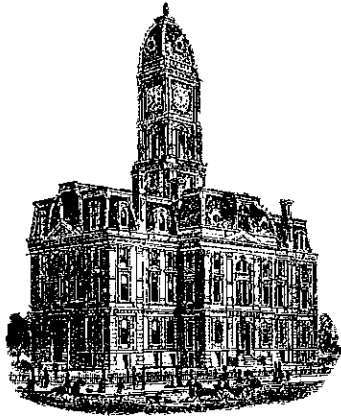

Kenton C. Ward, CFM  
Surveyor of Hamilton County  
Phone (317) 776-8495  
Fax (317) 776-9628

Suite 188  
One Hamilton County Square  
Noblesville, Indiana 46060-2230

To: Hamilton County Drainage Board

April 3, 2012

**Re: Windjammer Drain Extension (Revised Final Report)**

Attached are asbuilts and other information for the Windjammer Drain Extension. An inspection of the drainage facilities for this section has been made and the facilities were found to be complete and acceptable.

During construction of the drain there were not any significant changes made to the drain. Subsequently, there were not any significant changes made to the plans submitted with my report dated November 21, 1989. Therefore, the length of the drain extension remains at 302 feet. **The revised footage is 183 feet of 36" CMP. This revision is due to the survey conducted on the pipe for the 2009 Windjammer Reconstruction. This survey tied down in more detail the structures installed and the length of pipe involved with the 1989 Extension.**

The additional easement is located on Lot 263 in Masthead Section 8 and is recorded as instrument number #8913832.

The bond or letter of credit was not required since the project was completed on maintenance.

I recommend the Board approve the drains construction as complete and acceptable.

Sincerely,

Kenton C. Ward, CFM  
Hamilton County Surveyor

KCW/slm

Survey By HCSO-2009

FALL CREEK ROAD

TBM

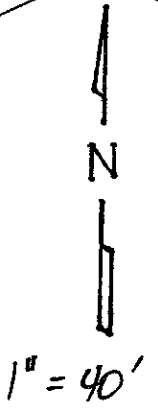

LOT 264

LOT 263

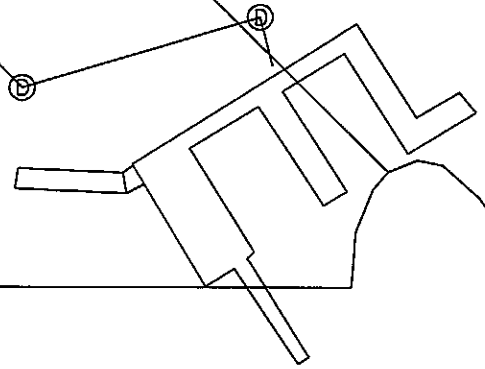



SURVEYOR'S OFFICE

# Hamilton County

Kenton C. Ward, Surveyor

776-9626

942 Maple Avenue

Noblesville, Indiana 46060

November 21, 1989

TO: Hamilton County Drainage Board

RE: Windjammer Drain

*2/20 Tuesday  
9:00 AM  
mail  
JA*

Attached is a petition for the extension of the Windjammer Drain filed by the County Commissioners. The extension involves a section of storm sewer between Fall Creek Road and Geist Reservoir. Included with the petition is a plan of the drain, drainage assessment roll, and an easement.

As per the report dated May 30, 1989 for the Windjammer Drain, the regulated drain ends at north side of Fall Creek Road at the north end of a 36" pipe. This proposal will extend the drain from the above described point to the Geist Reservoir. The drain extension will consist of 302 feet of 36" CMP.

Easement for the drain was increased from that which was platted as part of sections 8 and 9 of the Masthead Subdivision. The additional easement is located on Lot 263 in Masthead Section 8 and is recorded as instrument number 8913832.

As part of the Windjammer Drain, this portion described above as the extension and shown on the plan will be covered under the maintenance program established for the Windjammer Drain. Two parcels should be added to the maintenance assessment for Windjammer. These parcels are Lot 263, Masthead Section 8, Parcel 13-15-09-03-02-001.000 and Lot 264, Masthead Section 9, Parcel 13-15-09-00-01-001.000.

These tracts should be assessed the same as the other tracts in the Windjammer Drain at the rate of \$30.00 per lot.

I recommend a hearing be set for this matter in January, 1990.

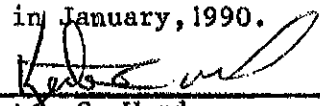
  
\_\_\_\_\_  
Kenton C. Ward,  
Hamilton County Surveyor

KCW/jb

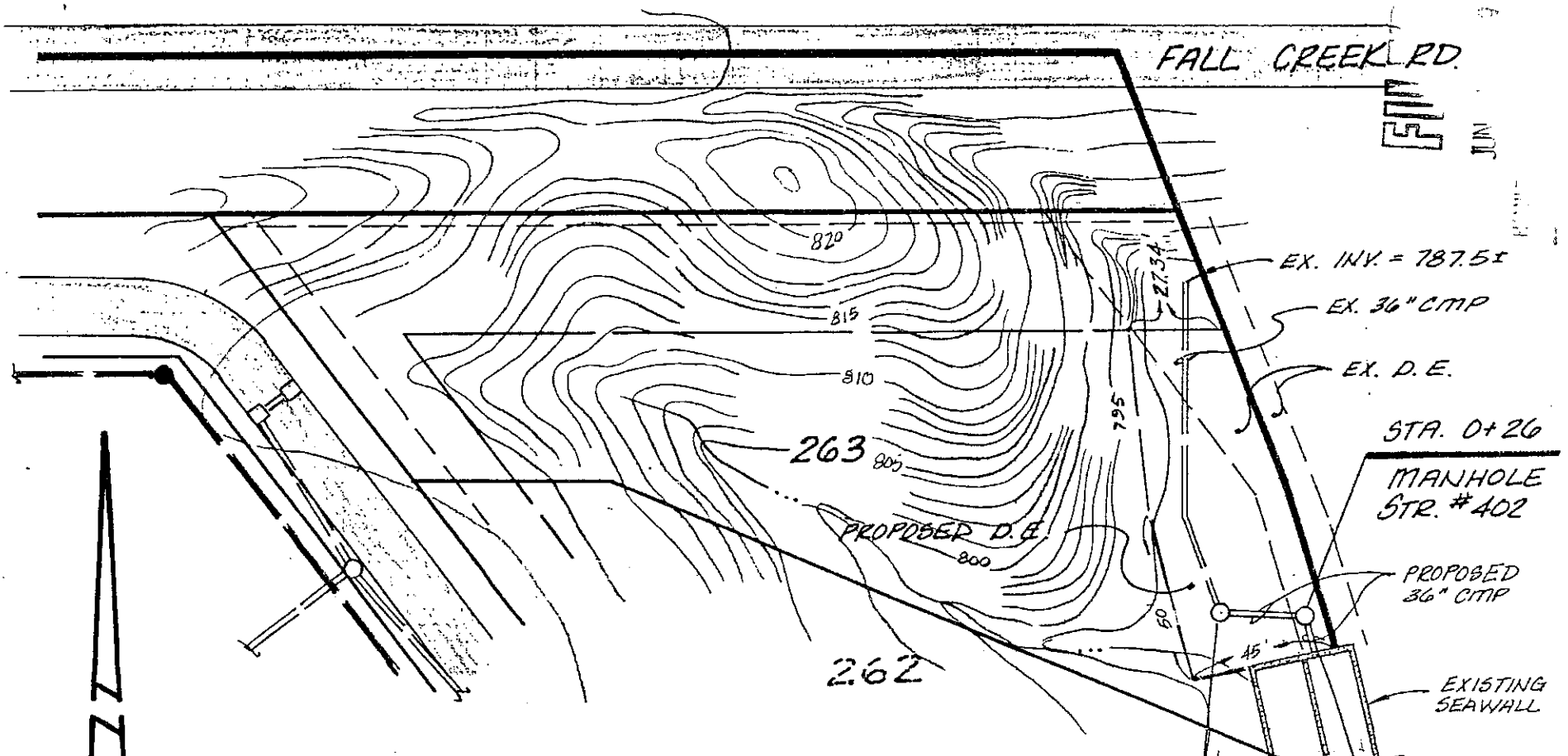

**SITE PLAN**

SCALE : 1" = 50'

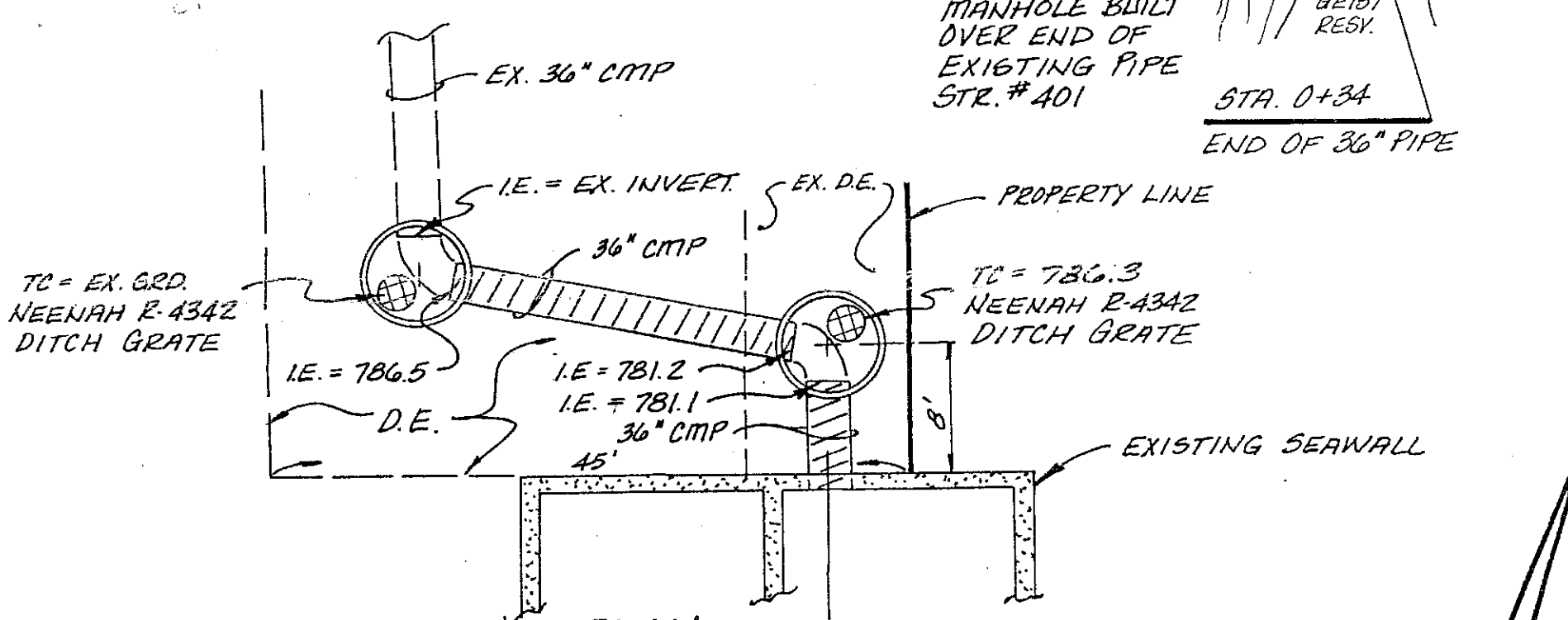

**PLAN**

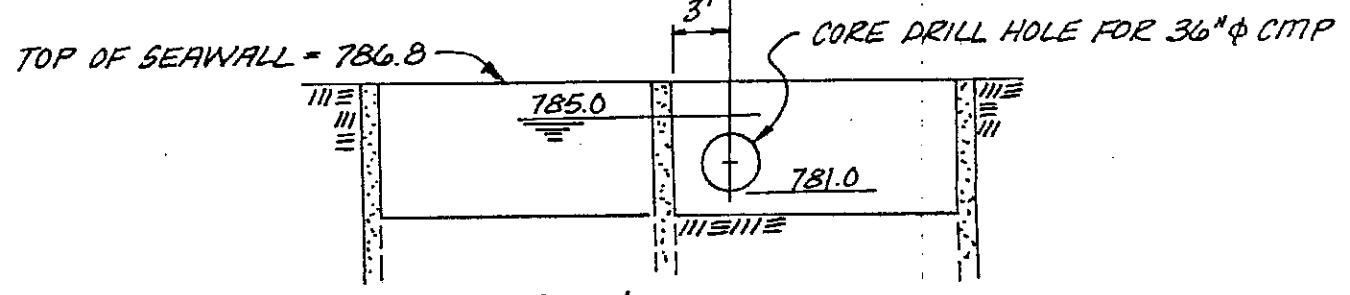

**SECTION**

**ENLARGED VIEW**

SCALE : 1" = 10'

**DRAINAGE EXHIBIT  
FOR  
MASTHEAD SEC. 8 , LOT 263**

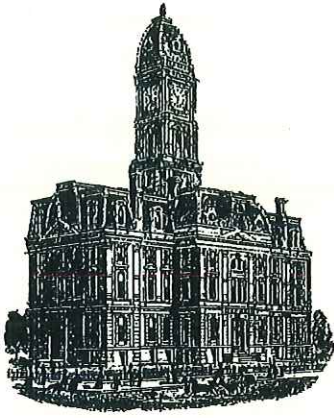

*Kenton C. Ward, CFM*  
*Surveyor of Hamilton County*  
*Phone (317) 776-8495*  
*Fax (317) 776-9628*

*Suite 188*  
*One Hamilton County Square*  
*Noblesville, Indiana 46060-2230*

### *Map Correction-Field Verification*

**Drain Number:** 218

**Drain Length:** 183

**Drain Name:** Windjammer -1989 Extension

**Change + / - :** 124

**Date:** 09-16-2016

**New Length:** 307

**Verified By:** SLM

---

#### **Notes & Sketch:**

At the time of the proposed Reconstruction of this segment of drain, a survey was conducted that did not include the 36" RCP\_CMP under Fall Creek Road. This led to some confusion to the actual make of the drain, as the original Windjammer1989 as-built called only for an 18" CMP and the 1989 Extension Report called for all 36" CMP. Thus a revised final was written to correct the footage from 302 feet to 183 feet. However, once the reconstruction commenced the 36" CMP was located was then repaired with the 2009 Reconstruction. Therefore, the footage of this pipe should be included in the overall length of drain.

**Suzanne L. Mills**  
**GIS Specialist**



